



**Poll Everywhere**

# **Poll Everywhere**

**A Tech Tip**

**by James McLendon**

**MEDT 6467**

**Spring, 2011**

What is poll everywhere?

**Poll Everywhere** is an affordable audience response system.

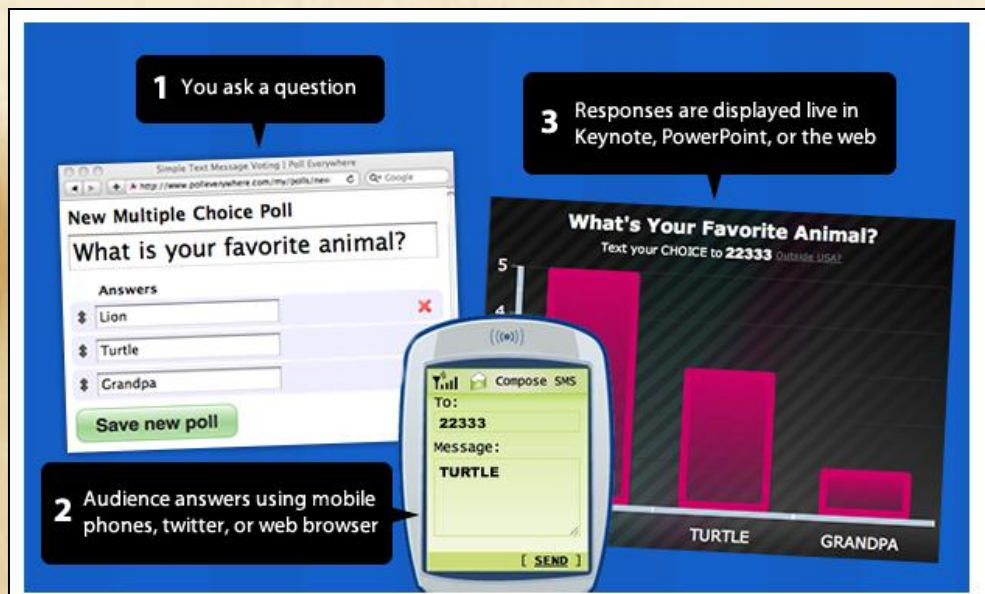



does it belong  
in the  
classroom?

Many student response systems are prohibitively expensive.

**Poll Everywhere** is free for classes with up to 32 students per section.

Teachers can use it to:

- increase participation
- elicit immediate feedback during presentations
- create informal assessments to guide instruction

how does  
it work?

The first step is to navigate in  
your preferred browser to:

[www.polleverywhere.com](http://www.polleverywhere.com)

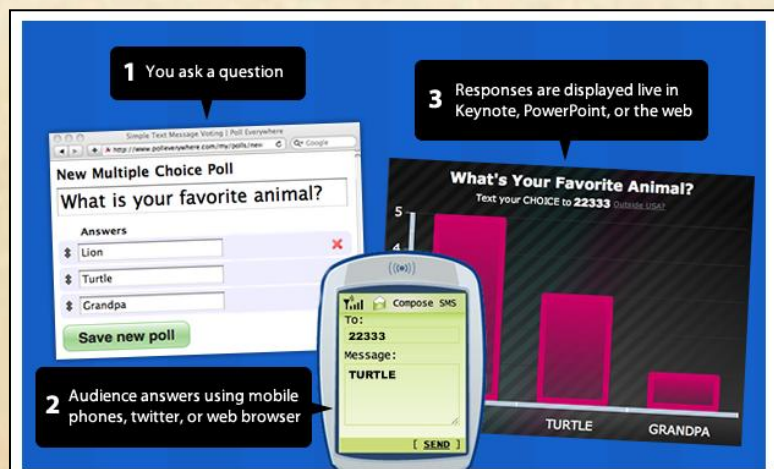

# Pricing

It is important to note the price plans before setting up your account to make sure it will meet your needs. Click “Pricing” at the top of the page.

There are several price points available with special options for educators, including a free plan.

	K-12 Free	Individual Teacher \$50/year	School-wide Minimum 200 students	District-wide Minimum 200 students
	 <a href="#">Sign Up</a>	<a href="#">Sign Up</a>	<a href="#">Contact Us</a>	<a href="#">Contact Us</a>
<b>Classroom Size</b> Unlimited number of classes (?)	32	40	80	80
<b>Teachers</b>	1	1	Unlimited	Unlimited
<b>Grade Reporting</b> See each students' answers	<a href="#">Explain</a>	✓	✓	✓
<b>Response Moderation</b> Approve what's shown on-screen	<a href="#">Explain</a>	✓	✓	✓
<b>Custom Keywords</b> Four or more characters (?)	<a href="#">Explain</a>		✓	✓
<b>Team Scoring</b> Run live competitions and comparisons (?)		✓	✓	✓
<b>Technical Support</b>	FAQ	FAQ, Email	Tier 2 Support	Tier 2 Support

# Creating an Account

After clicking on “Sign Up”, you will be prompted to enter your name, email, and a password. You will also need to agree to the *Terms of Service*. This is all it takes to get started.

## K-12 Free Plan Signup

This is your last stop before you're creating polls.

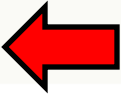
<b>Full name</b> <input type="text"/>	<b>Instant setup</b> In about 30 seconds you'll be creating text message and web enabled polls.
<b>Email</b> <input type="text"/>	<b>Everything you need</b> No additional hardware, setup, or contracts required. We did all of the grunt-work for you; everything works through the web.
<b>Password</b> <input type="password"/>	<b>Captivate your audience</b> Create amazing presentations by showing your polls right in PowerPoint.
<b>What country will people be texting us from?</b> <input checked="" type="radio"/> United States - Education <a href="#">Coverage Details...</a> <a href="#">» Show more countries...</a>	<b>Global reach</b> Poll everywhere via our international text messaging service and web voting.
<b>Agreement</b> <input type="checkbox"/> I agree to the <a href="#">Terms of Service</a> , <a href="#">Privacy Policy</a> , and <a href="#">Refund &amp; Payment Policy</a>	
<input type="button" value="Sign up for my Poll Everywhere account"/>	 Click this button to continue when ready.

# Accessing Your Account

On future visits, you will be able to click on “login” and will be presented a different screen to login.

Use the information you entered when you created your account.

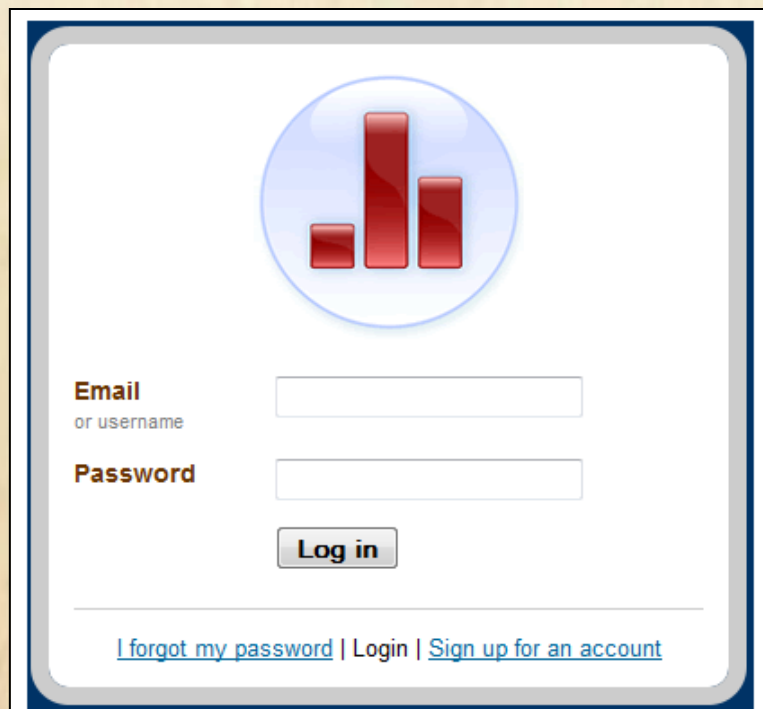

The image shows a login form with a blue border. At the top center is a circular icon containing a red bar chart with three bars of increasing height. Below the icon are two input fields. The first is labeled "Email" and "or username". The second is labeled "Password". Below the password field is a "Log in" button. At the bottom, there is a horizontal line and three links: "I forgot my password", "Login", and "Sign up for an account".

**Email**  
or username

**Password**

**Log in**

---

[I forgot my password](#) | [Login](#) | [Sign up for an account](#)



# Setting Up a Poll

Your first decision will be what kind of poll to setup.

Choose the poll that fits your needs best.

The first example is the “Multiple choice poll”.

### Create New Poll

<b>Multiple choice poll</b> "Choose your favorite color"	<b>Free text poll</b> "What is your name?"	<b>Goal poll</b> "Set goals or raise money"
		
<b>What is it?</b> With multiple choice polls, you define a list of possible answers. Graphs will display the results in real-time.	<b>What is it?</b> Your audience can text in anything. Gather feedback or identifying information, like names or ID numbers.	<b>What is it?</b> People text in numbers and a thermometer climbs towards a goal. Use this to track pledges, donations, or sales goals.



# Multiple Choice Poll

Enter a question that fits your lesson for the day.

Enter a few choices for the students to select. Use the same selection process you would when building a quiz or test item.

### New Multiple Choice Poll

Ask your audience a short question and provide a few answers to choose from.

**Question**  
Ask "What is your favorite color" with answers "Red", "Blue", & "Green"

Which literary device compares two unlike things using "like" or "as"?

Answers	Keywords (?)
<input type="text" value="alliteration"/>	AUTO KEYWORD Customize this keyword <span>✕</span>
<input type="text" value="metaphor"/>	AUTO KEYWORD Customize this keyword <span>✕</span>
<input type="text" value="onomatopoeia"/>	AUTO KEYWORD Customize this keyword <span>✕</span>
<input type="text" value="simile"/>	AUTO KEYWORD Customize this keyword <span>✕</span>

or [cancel creating poll](#)



You may choose to add more options than offered. When your question is ready, click on "Save new poll".

# Multiple Choice Poll

You also have options to adjust the poll. Select the options that meet your needs best; the question you ask may require specific options.

**▼ Responses**

Each person may respond

up to  time

as much as they like

Depending on the question asked, more than one response may be less effective.

This option is for a message will receive confirming their response was sent.

**▼ Reply Message**

No message

Default message

Custom message (?)

**▼ How People Can Respond**

Text messages from the US - Education

Tweets to @poll (?)

Smartphones via poll4.com (?)

Web widget (?)

These are options for students to use other than the SMS feature of their ubiquitous cell phones.

# Multiple Choice Poll

Next you will see your poll in the default settings.

Hovering over the right side of your poll offers choices for settings and appearance.

There is also an option to make the poll full screen.

This feature could be used as a warm-up activity.

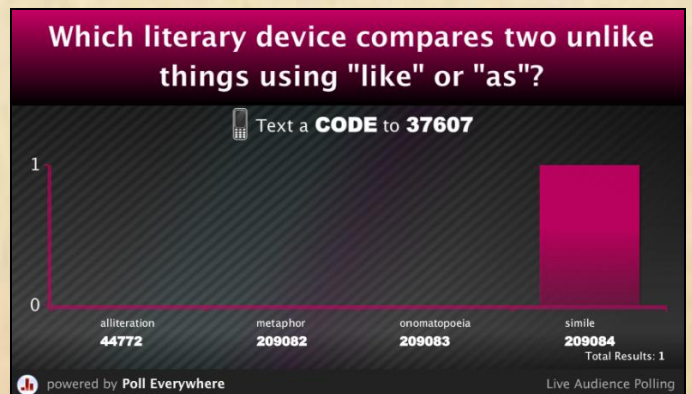
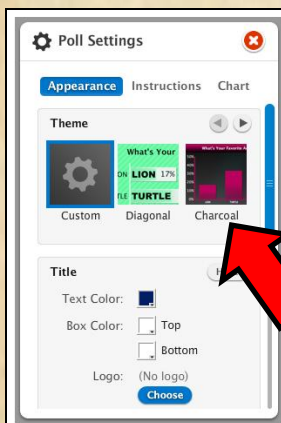
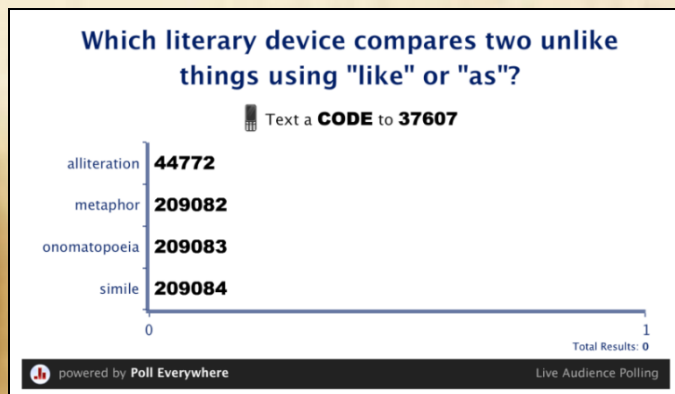

# Multiple Choice Poll

Along the right side of the window are poll management tools.

From this tool bar, you can edit your poll or change how your poll is displayed.

Perhaps one of the most impressive features is the PowerPoint Slide Download.

Using this feature you can embed your poll(s) into a PowerPoint presentation. These polls can then be displayed in real-time in class as students reply.

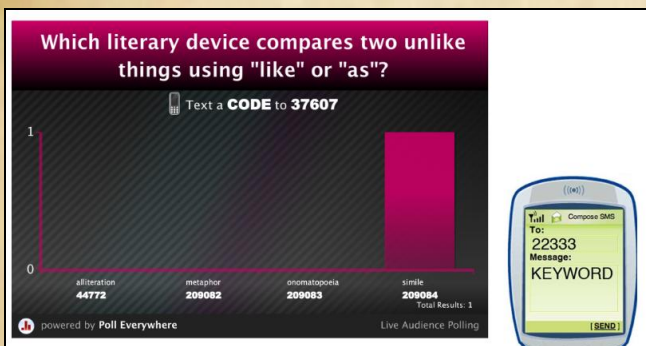

**Stop Poll**

Edit Copy  
Clear Results Delete

▼ Views

Live Chart  
Summary Table  
Response History  
Static Chart

► Ways People Can Respond

► Download as Slide

► Share and Publish

# Free Text Polls

Other poll formats allow students the freedom to enter whatever text they like.

This could include questions for the teacher. Using this feature allows some less reluctant students to voice their concerns and allow them to take appropriate risks in class.

**Which of the poems listed on the board would you like to read next?**

 Text **209575** and your message to **37607**

**"oranges"**

less than a minute ago

**"none of them"**

1 minute ago

**"the raven"**

1 minute ago

Use this feature with caution, as the free version does not allow moderation or filtering of responses; certain students may like to exploit this situation.

# Managing Your Polls

By clicking on “My Polls”, you will have options to start, stop, download, clear results, and delete your polls.

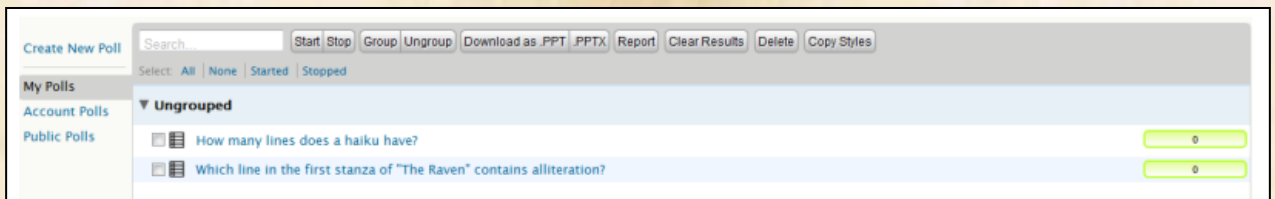

This dashboard is also where you can group your polls according to class or whichever category will help you keep them organized.

# Your Polls

Now it falls to you.

Get out there; create your own polls!

Good Luck, and enjoy!